

DF5 Series DomePak®

COMPLETE, FIXED MOUNT DOME, CAMERA AND LENS PACKAGE

Product Features

- Pre-Packaged Dome, Camera, and Lens
- Easy to Order
- Cosmetically Matches Spectra® Dome
- Indoor and Environmental Models Available
- Hard Ceiling, Suspended Ceiling, and Pendant Applications
- Versatile and Adjustable Fixed Mount Camera Bracket
- High Resolution Color
- Varifocal and Fixed Lens Options
- Pendant Models Meet NEMA Type 4X and IP66 Standards
- Heavy-Duty Models
 - Tough, Reinforced Construction
 - 0.090-inch Injection-Molded Polycarbonate Bubble
 - Barrel-Type Key Locks



DF5 DomePaks® combine a fixed-mount dome enclosure, compact high-resolution camera, and fixed or varifocal lens in an easy-to-order, easy-to-install package.

DF5 DomePaks are packaged under a single part number to make ordering easier; and, because they are pre-configured, they are guaranteed to be compatible.

DF5 DomePaks are available in a variety of styles for different applications. Select from in-ceiling, pendant (indoor or outdoor), or heavy-duty models. And, because they are designed to look like Spectra® integrated dome systems, they are the perfect complement to new or existing installations.

DomePak allows choices between color (NTSC or PAL), high resolution compact cameras and a variety of lenses ranging from 2.3 mm to 5-50 mm fixed focal length or varifocal length, and 2.8-11, 3-8.5 and 7.5-50 varifocal day/night lenses. Choose between auto or manual iris.

DF5 DomePaks are fashioned after Spectra integrated dome systems, and have a variety of mounting options available, from wall, corner, pole, or parapet mount.

For fixed dome applications requiring specialty enclosures such as stainless steel or pressurized, see Spectra with DD5-FM fixed mount camera adapter.



C1452 / REVISED 6-19-08



U.S. Patents 340,940 and 5,224,675

International Standards
Organization Registered Firm;
ISO 9001 Quality System



TECHNICAL SPECIFICATIONS

DOME

MECHANICAL

Cable Entry	
In-ceiling	0.75-inch conduit fitting
Pendant	Through 1.5-inch NPT pendant mount

ELECTRICAL

Input Voltage	24 VAC (environmental models only)
Input Power	58 VA (for heater)

GENERAL

Construction	
Back Box	Aluminum
Mounting Bracket	Steel
Bubble	
DF5, DF5S,	
DF5-PG Series	Acrylic; smoked, clear, chrome* or gold*
DF5-HD Series	Polycarbonate; clear, 0.090-inch thick
DF5-OF	Acrylic (flat window); smoked, 0.06-inch thick

ENVIRONMENTAL

Environment	
Outdoor [†]	(DF5-PG-E0, DF5-PG-E1, or DF5HD-PG-E1)
Maximum	140°F (60°C) absolute maximum; 122°F (50°C) sustained maximum
Minimum	-60°F (-51°C) absolute minimum; prevents icing at sustained minimum of -50°F (-45°C); de-ices 0.1 inch (2.5 mm) within 3 hours after power-up
Indoor	(All other models) 32° to 122°F (0° to 50°C)

*Available only with standard in-ceiling models.

[†]Assumes no wind chill factor.

CERTIFICATIONS/PATENTS

- UL/cUL Listed
- Meets NEMA Type 1, IP20 standards (indoor models)
- Meets NEMA Type 4, IP66 standards (outdoor models)
- U.S. Patents 340,940 and 5,224,675

RECOMMENDED MOUNTS

In-Ceiling Domes

DF5S-SMKIT	Surface mount adapter for DF5S Series with short back box. Includes bezel and hardware.
SCA1	Support rails; use in suspended ceiling applications where additional support is needed.
SD5-P	2' x 2' drop ceiling panel, aluminum construction. Replaces 2' x 2' ceiling tile.

Pendant Domes

BB5-PCA-BK	Conduit adapter, black
BB5-PCA-GY	Conduit adapter, gray
IWM Series	Wall mount with cable feedthrough. Can be adapted for corner (CM400), pole (PA402) or parapet (PP300L/PP301L, PP400, PP4348) applications.
PP350, PP351	Parapet mount; mounts to inside of parapet
SWM Series	Compact wall mount. Can be adapted for corner (SWM-CA) or pole (SWM-PA) applications.

RECOMMENDED POWER SUPPLIES

MCS Series	Multiple 24 VAC camera power supply, indoor
WCS Series	Single/multiple 24 VAC camera power supply, outdoor

TECHNICAL SPECIFICATIONS

LETTER	MODEL	DIMENSION
A	DF5S SERIES	2.75 (6.99)
B	DF5 SERIES	5.25 (13.34)
C	DF5-0F/DF5-1F	5.60 (14.22)

**STANDARD,
IN-CEILING**

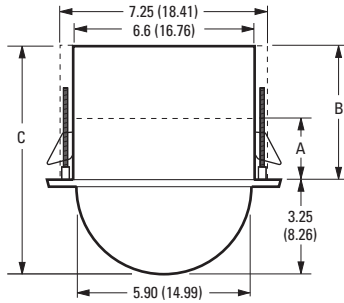

**STANDARD,
PENDANT**

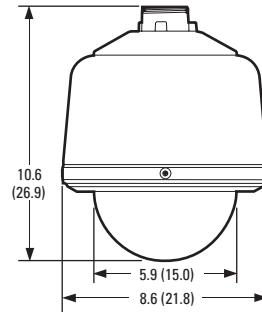

**HEAVY-DUTY,
IN-CEILING**

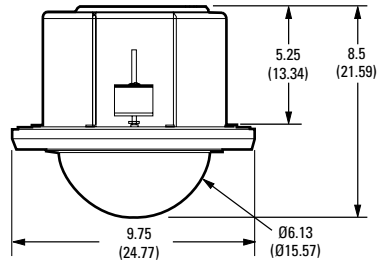

**HEAVY-DUTY,
PENDANT**

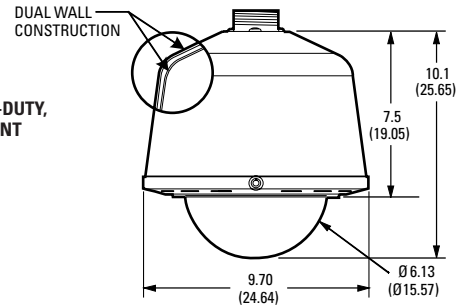

NOTE: VALUES IN PARENTHESES ARE CENTIMETERS; ALL OTHERS ARE INCHES.

TECHNICAL SPECIFICATIONS

CAMERA SPECIFICATIONS

	High Resolution, Day/Night, WDR (NTSC) CCC1390H-6 (KW)	High Resolution, Day/Night, WDR (PAL) CCC1390H-6X (KX)
Image Device	1/3-inch image format Sony SS-2WD CCD	1/3-inch image format Sony SS-2WD CCD
Synchronization System	AC line lock/internal	AC line lock/internal
Horizontal Resolution	530 TVL (B-W); 480 TVL (color)	530 TVL (B-W); 480 TVL (color)
Electronic Shutter Range	1/60-1/50,000 second	1/50-1/50,000 second
Minimum Illumination		
B-W (SENS 40x)	0.002 lux, f1.2, 40 IRE, AGC on, 75% scene reflectance	0.002 lux, f1.2, 40 IRE, AGC on, 75% scene reflectance
Color (SENS 40x)	0.02 lux, f1.2, 40 IRE, AGC on, 75% scene reflectance	0.02 lux, f1.2, 40 IRE, AGC on, 75% scene reflectance
B-W	0.08 lux, f1.2, 40 IRE, AGC on, 75% scene reflectance	0.08 lux, f1.2, 40 IRE, AGC on, 75% scene reflectance
Color	0.8 lux, f1.2, 40 IRE, AGC on, 75% scene reflectance	0.8 lux, f1.2, 40 IRE, AGC on, 75% scene reflectance
Signal-to-Noise Ratio	>50 dB	>50 dB
Automatic Gain Control	Selectable	Selectable
Backlight Compensation	Selectable	Selectable
Scanning System	525 lines, 2:1 interlace	625 lines, 2:1 interlace
Signal Processing	Digital signal processing (DSP)	Digital signal processing (DSP)
Auto Iris Lens Type	DC-drive (autosensing)	DC-drive (autosensing)
Video Output	1 Vp-p, 75 ohms	1 Vp-p, 75 ohms
Input Voltage	24 VDC ±15%/12 VDC ±15%, 60 Hz	24 VDC ±15%/12 VDC ±15%, 50 Hz
Power Consumption	3.5 watt	3.5 watt
	Ultra High Resolution, Day/Night (NTSC) C10DN-6 (AM)	Ultra High Resolution, Day/Night (PAL) C10DN-6X (AN)
Image Device	1/3-inch image format interline transfer CCD	1/3-inch image format interline transfer CCD
Synchronization System	AC line lock/internal	AC line lock/internal
Horizontal Resolution	540 TVL	540 TVL
Electronic Shutter Range	1/60-1/100,000 second	1/50-1/100,000 second
Minimum Illumination		
B-W (SENS 40x)	0.08 lux, f1.2, 50 IRE, AGC on, 89% scene reflectance	0.08 lux, f1.2, 50 IRE, AGC on, 89% scene reflectance
Color (SENS 40x)	0.4 lux, f1.2, 50 IRE, AGC on, 89% scene reflectance	0.4 lux, f1.2, 50 IRE, AGC on, 89% scene reflectance
B-W	0.07 lux, f1.2, 40 IRE, AGC on, 75% scene reflectance	0.07 lux, f1.2, 40 IRE, AGC on, 75% scene reflectance
Color	0.3 lux, f1.2, 40 IRE, AGC on, 75% scene reflectance	0.3 lux, f1.2, 40 IRE, AGC on, 75% scene reflectance
Signal-to-Noise Ratio	>48 dB	>48 dB
Automatic Gain Control	Selectable	Selectable
Backlight Compensation	Selectable	Selectable
Scanning System	525 lines, 2:1 interlace	625 lines, 2:1 interlace
Signal Processing	Digital signal processing (DSP)	Digital signal processing (DSP)
Auto Iris Lens Type	DC-drive (autosensing)	DC-drive (autosensing)
Video Output	1 Vp-p, 75 ohms	1 Vp-p, 75 ohms
Input Voltage	24 VAC ±15%/12 VDC ±15%, 60 Hz	24 VAC ±15%/12 VDC ±15%, 50 Hz
Power Consumption	3 watts	3 watts
	Ultra High Resolution, Color, NTSC C10CH-6 (AJ)	Ultra High Resolution, Color, PAL C10CH-6X (AK)
Image Device	1/3-inch image format interline transfer CCD	1/3-inch image format interline transfer CCD
Synchronization System	AC line lock/internal	AC line lock/internal
Horizontal Resolution	540 TVL	540 TVL
Electronic Shutter Control	Selectable	Selectable
Minimum Illumination	0.3 lux, f1.2, 40 IRE, AGC on, 75% reflectance	0.3 lux, f1.2, 40 IRE, AGC on, 75% reflectance
Signal-to-Noise Ratio	>48 dB	>48 dB
Automatic Gain Control	Selectable	Selectable
Backlight Compensation	Selectable	Selectable
Scanning System	525 lines, 2:1 interlace	625 lines, 2:1 interlace
Signal Processing	Digital signal processing (DSP)	Digital signal processing (DSP)
Auto Iris Lens Type	DC-drive (autosensing)	DC-drive (autosensing)
Video Output	1 Vp-p, 75 ohms	1 Vp-p, 75 ohms
Input Voltage	24 VAC ±15%/12 VDC ±15%, 60 Hz	24 VAC ±15%/12 VDC ±15%, 50 Hz
Power Consumption	3 watts	3 watts

TECHNICAL SPECIFICATIONS

LENS SPECIFICATIONS

Varifocal Day/Night Lenses	R2.8	R3	R75
Focal Length	2.8-11 mm	3-8.5 mm	7.5-50 mm
Zoom Ratio	3.9X	2.8X	6.7X
Format Size	1/3-inch	1/3-inch	1/3-inch
Mount Type	CS	CS	CS
Relative Aperture (F)	1.4-2.6	1.0-360	1.3-360
Operation			
Iris	Auto (Direct Drive)	Auto (Direct Drive)	Auto (Direct Drive)
Focus and Zoom	Manual	Manual	Manual
Angle of View			
Diagonal	32.7°~123.2°	41.9 °~114.1°	7.00°~46.2°
Horizontal	26.2°~97.4°	33.6°~90.5°	5.64°~36.6°
Vertical	19.7°~72.4°	25.2°~67.2°	4.26°~27.4°
Min. Object Distance	0.3 m	0.2 m	0.4 m

Varifocal Lenses	V2	V21	V3	V5	V50
Focal Length	2.5-6 mm	2.8-12 mm	3-8 mm	5-40 mm	5-50 mm
Zoom Ratio	2.4X	4.3X	2.7X	8X	10X
Format Size	1/3-inch	1/3-inch	1/3-inch	1/3-inch	1/3-inch
Mount Type	CS	CS	CS	CS	CS
Relative Aperture (F)	1.4~Close/1.4~125	1.4~Close/1.4~360	1.0~Close/1.0~360	1.6~Close/1.6~360	1.4~Close/1.4~185
Operation					
Iris	Manual/Auto (Direct Drive)	Manual/Auto (Direct Drive)	Manual/Auto (Direct Drive)	Manual/Auto (Direct Drive)	Manual/Auto (Direct Drive)
Focus and Zoom	Manual	Manual	Manual	Manual	Manual
Angle of View					
Diagonal	56.8 °~133.3°	—	44.9°~117.9°	8.8 °~66.9°	—
Horizontal	45.6°~107.6°	24.1°~97.4°	35.9°~91.0°	6.5°~53.6°	5.3°~53.4°
Vertical	34.2°~80.9°	18.1°~72.5°	26.9°~66.6°	4.8°~40.2°	4.1°~40.1°
Min. Object Distance	0.2m	0.3m	0.2m	0.5m	0.5m

Fixed Focal Lenses	F2.3	F2.8	F4	F8
Focal Length	2.3 mm	2.8 mm	4 mm	8 mm
Format Size	1/3-inch	1/3-inch	1/3-inch	1/3-inch
Mount Type	CS	CS	CS	CS
Relative Aperture (F)	1.4~Close/1.4~360	1.4~Close/1.4~360	1.2~Close/1.2~360	1.2~Close/1.2~360
Operation				
Iris	Manual/Auto (Direct Drive)	Manual/Auto (Direct Drive)	Manual/Auto (Direct Drive)	Manual/Auto (Direct Drive)
Focus	Manual	Manual	Manual	Manual
Angle of View				
Diagonal	143.2°	121.8°	92.3°	43.8°
Horizontal	116.1°	97.4°	71.6°	34.5°
Vertical	87.4°	72.8°	52.7°	25.6°
Min. Object Distance	0.2m	0.2m	0.2m	0.2m

MODEL NUMBERS

To configure a DF5 DomePak, refer to the selection guides below to compile the appropriate model number. Selection guides are grouped according to dome type.



**DF5 SERIES
IN-CEILING**



**DF5S SERIES
SHORTENED BACK BOX**



**DF5 SERIES
PENDANT**



DH5 HEAVY DUTY

In-Ceiling and Pendant Models, Standard Bubble

DF5KW-PB-0F2.3A

- DF5** = Standard DF5
- DF5S** = Shortened DF5 (In-ceiling only)
- DH5** = Heavy duty DF5
- KW** = Day/night, NTSC, high resolution with WDR
- KX** = Day/night, PAL, high resolution with WDR
- AM** = Day/night, ultra high resolution (NTSC)
- AN** = Day/night, ultra high resolution (PAL)
- AJ** = Color, ultra high resolution (NTSC)
- AK** = Color, ultra high resolution (PAL)
- PB** = Pendant, black (indoor)*
- PG** = Pendant, light gray (indoor/outdoor)
- Blank** = In-ceiling back box
- 0** = Smoked dome (f/0.5 light loss)*
- 1** = Clear dome
- 2** = Chrome dome (f/2.0 light loss[†])
- 3** = Gold dome (f/2.0 light loss[†])
- E0** = Outdoor pendant (includes heater and sun shield), smoked dome (f/0.5 light loss)
- E1** = Outdoor pendant (includes heater and sun shield), clear dome
- R11** = 2.8-11 mm varifocal D/N lens[‡]
- R3** = 3-8.5 mm varifocal D/N lens[‡]
- R75** = 7.5-50 mm varifocal D/N lens[‡]
- V2** = 2.5-6 mm varifocal lens
- V21** = 2.8-12 mm varifocal lens
- V3** = 3-8 mm varifocal lens
- V5** = 5-40 mm varifocal lens
- V50** = 5-50 mm varifocal lens
- F2.3** = 2.3 mm fixed lens
- F2.8** = 2.8 mm fixed lens
- F4** = 4 mm fixed lens
- F8** = 8 mm fixed lens
- Blank** = No Lens
- A** = Auto iris
- Blank** = Manual iris

*Not available in heavy duty models.
[†]Available only with standard in-ceiling models.
[‡]Available only as an auto iris lens.

In-Ceiling Models with Flat Acrylic Plate



**DF5 WITH FLAT
ACRYLIC PLATE**

DF5KW-0F2.3A

- DF5** = Series dome
- KW** = Day/night, NTSC, high resolution with WDR
- KX** = Day/night, PAL, high resolution with WDR
- AM** = Day/night, ultra high resolution (NTSC)
- AN** = Day/night, ultra high resolution (PAL)
- AJ** = Color, ultra high resolution (NTSC)
- AK** = Color, ultra high resolution (PAL)
- 0F** = Smoked flat window (f/0.5 light loss)
- F2.3** = 2.3 mm fixed lens
- F2.8** = 2.8 mm fixed lens
- F4** = 4 mm fixed lens
- Blank** = No lens
- A** = Auto iris
- Blank** = Manual iris



Pelco, Inc. Worldwide Headquarters:
 3500 Pelco Way, Clovis, California 93612-5699 USA
USA & Canada Tel: (800) 289-9100 • FAX: (800) 289-9150
International Tel: +1 (559) 292-1981 • FAX: +1 (559) 348-1120
www.pelco.com

Pelco, the Pelco logo, DomePak, and Spectra are registered trademarks of Pelco, Inc.
 Product specifications and availability subject to change without notice.
 ©Copyright 2008, Pelco, Inc. All rights reserved.